



2024-2025

Living-Learning Themed Communities



WELCOME **Cardinals!**

On behalf of University Housing and the Resident Experience, I would like to congratulate you on your acceptance to the University of Louisville. By joining our Cardinal family, you have taken the first step in securing a college experience filled with unparalleled opportunity and support.

As you browse this booklet, you will notice that housing options exist for numerous living preferences and financial circumstances. Our goal is to provide you with as much flexibility as possible in finding a new home here on campus. We also continually strive to enhance your residential experience through Living-Learning (LLC) and Themed Communities (TC) and in-hall events and programs geared toward your success.

As you embark on this exciting journey, our team will be available to answer any questions, offer advice, and connect you to resources around campus. We look forward welcoming you to campus.

Go Cards!

Dr. Thomas Hardy
Executive Director of University Housing
and the Residence Experience





Cardinals!



On behalf of University Housing and the Resident Experience, welcome new and returning Cardinals! We continually strive to enhance your residential experience through Living-Learning and Themed Communities, in-hall events, and programs geared toward your student success. For the 2024-2025 academic year, we are proud to welcome back both new and returning Living-Learning (LLCs) and Themed Communities (TCs) for both first-year and upper-level students.

LLCs and TCs are located throughout our residence halls here on campus, where we provide students the opportunity to participate in high-impact communities. We believe there is a community for everyone, and by providing LLCs and TCs, we provide students with the opportunity to live together while accessing academic and staff support, leadership opportunities, and other resources tailored to their interest or goal.

As you embark on your 2023-2024 journey, our team will be available to answer any questions, offer advice, and connect you to resources around campus. We look forward to welcoming you to and back to our campus. Go Cards!

Catherine Wibbels
Assistant Director for Resident Learning

Housing Snapshot

Located in the heart of campus, our twelve residence halls place you at the center of student life. We offer traditional, suite, and apartment options, all within all within a ten minute walk from academic resources and student services. View amenities, room types, and rates at: louisville.edu/housing.

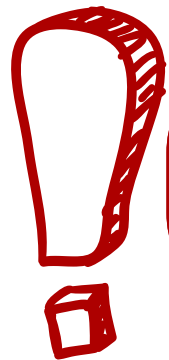

Nearly 65% of first-year students live on campus!

All first-year students under 21 are required to live on campus unless living at home locally with a parent and/ or guardian.

Second-year students can choose to live on campus or with a UofL-affiliated property. Our affiliates are The Nine, The Province, and The Retreat.



Traditional-Style Housing

Double occupancy rooms and a shared kitchen in each building.

- Belknap Village North
- Belknap Village South
- Unitas Tower

Suite-Style Housing

Semi-private bathroom options and a shared kitchen in each building.

- Community Park
- Billy Minardi Hall
- Kurz Hall
- Louisville Hall

Apartment-Style Housing

Various floor plans, bedroom and bathroom options offered with in-unit kitchens.

- Bettie Johnson Hall
- Cardinal Towne
- Denny Crum Hall
- University Pointe
- University Tower Apartments

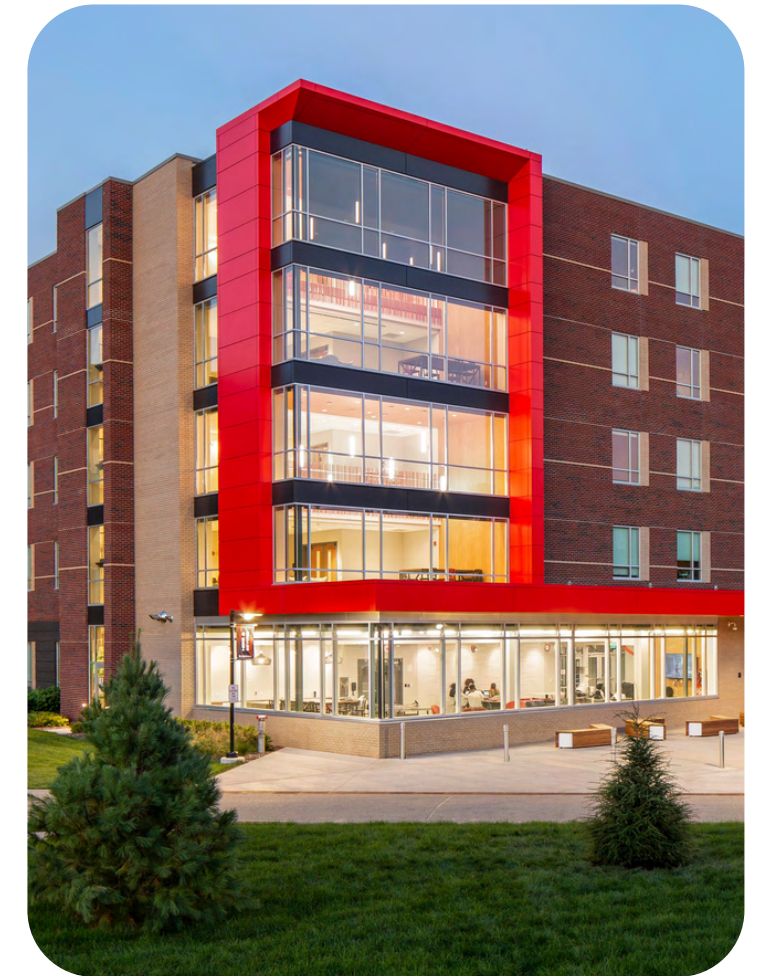

Living-Learning Themed Communities

One of the greatest perks of living on campus is the chance to join one of our Living-Learning (LLC) and Themed Communities (TC)!

LLCs are geared toward students who share an academic goal, major, or career. LLC participants will live together in a unique living environment and will also enroll and participate in courses together. TCs are geared towards students who share a common interest, identity, activity, or hobby.

All communities will participate in community development and improvement opportunities throughout the campus and local community.

LLCs and TCs provide the opportunity for students with shared interests to live together in the same section of a residence hall. Members access tailor-made academic and staff support, leadership opportunities, social events, and more. In addition, LLC members participate in select courses together.

Just this past year, nearly half of all first-year housing applicants chose to apply for an LLC or TC. Here are a few reasons why:



Higher GPA

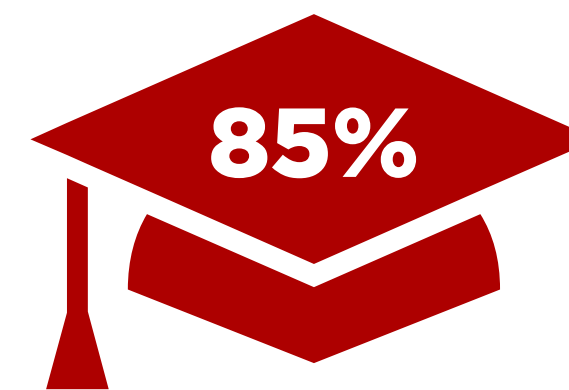

Higher Retention

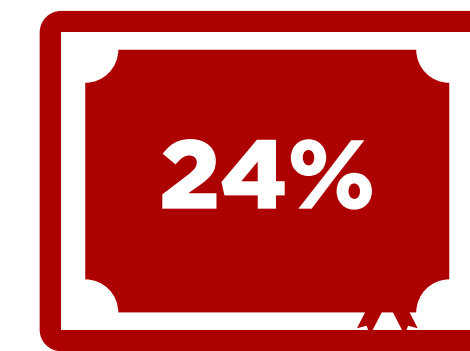

Dean's List



Learn more and apply at
louisville.edu/housing

LLC

FIRST-YEAR

LIVING-LEARNING COMMUNITIES



Air Force ROTC & Army ROTC

Kurz Hall

In partnership with the Army ROTC and Air Force ROTC, the ROTC LLC brings together students and cadets that are wishing to pursue a career in the Army or the Air Force. This residential community provides an opportunity build strong relationship with other cadets and get to engage together outside of ROTC-related events.



BioBridges

Belknap Village South



Interested in biology but not sure where to start? The BioBridges LLC is an academic community that fosters fun and interest in “all things biological”.

As a BioBridge-LLC student, you will build a strong community, have access to mentorship by current post-doctoral research fellows and peers, meet faculty outside of classes, increase awareness to potential research experiences in labs within the biology department, get study support and broaden your interests and career goals in the life sciences

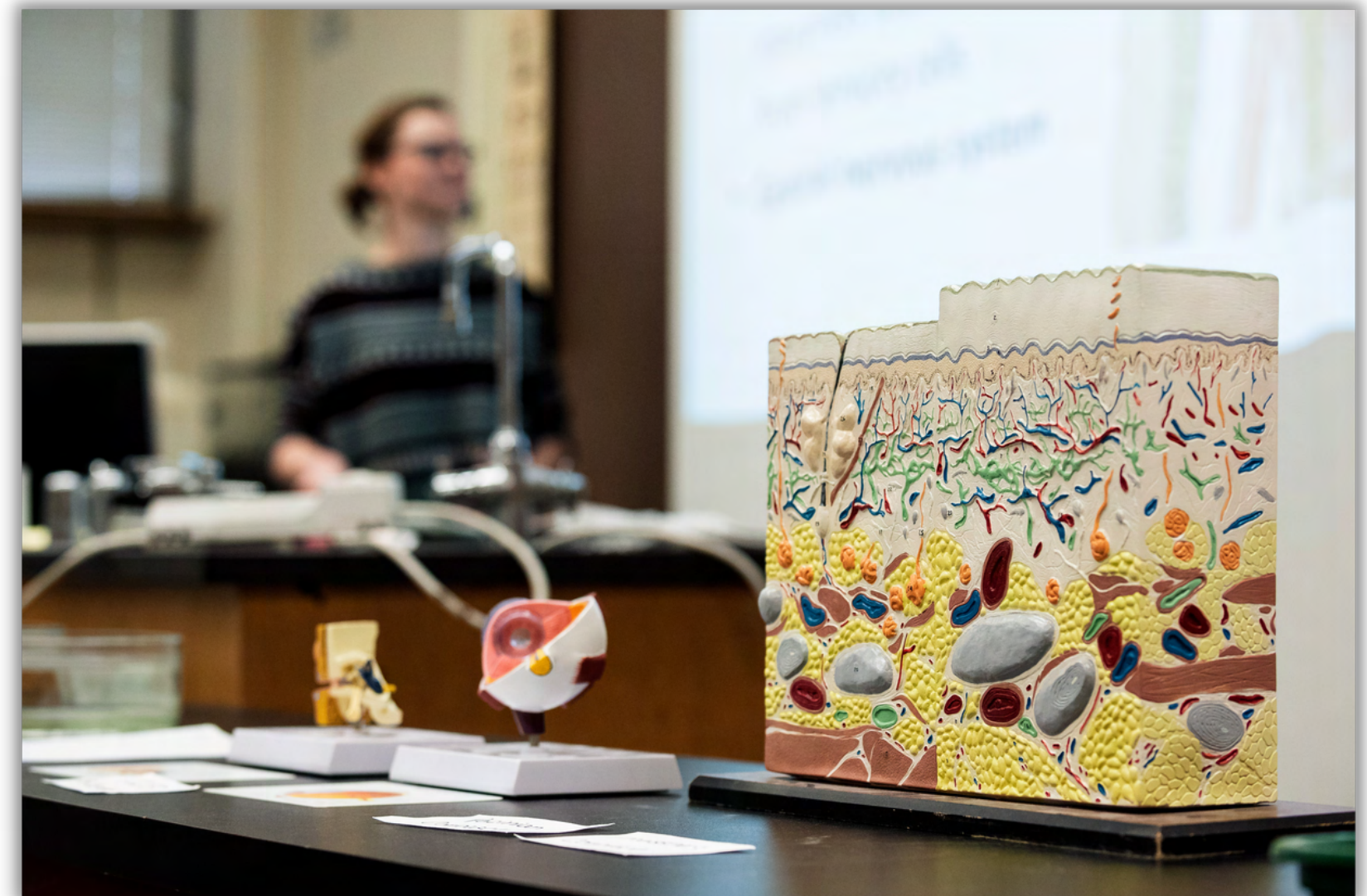



College of Business

Louisville Hall

This LLC is designed for students majoring in business who want to develop their individual leadership style, while engaging with faculty, staff, professionals, and their LLC cohort of future business professionals. This community emphasizes the importance of academic achievement, navigating life's transitions, and how to use innovation to solve problems





Education and Health & Sports Science

Belknap Village North

The Education and Health & Sport Sciences provides any undergraduate major housed in the College of Education and Human Development the opportunity to explore skills related to their field as well as understand, collaborate with, and support their peers and the Louisville community. Participants of this LLC will live on the same floor, take classes together based on major, and receive specialized programming focusing on academic and social integration.



Engineering

Community Park



This LLC provides personal, academic, and professional support to first-year engineering students through various programs and activities throughout the year. As a member of the ELLC, you will have access to: On-site tutoring services for calculus, chemistry, and physics provided by Resources for Academic Achievement (REACH); Peer mentoring by a Speed School upperclassman, who holds weekly office hours in the ELLC residence hall and communicates regularly with ELLC members; Academic counseling by academic advisors, who hold weekly office hours in the ELLC residence hall; Engineering-based programming to improve study skills, explore careers, and network with peers and professionals; Social and wellness events.

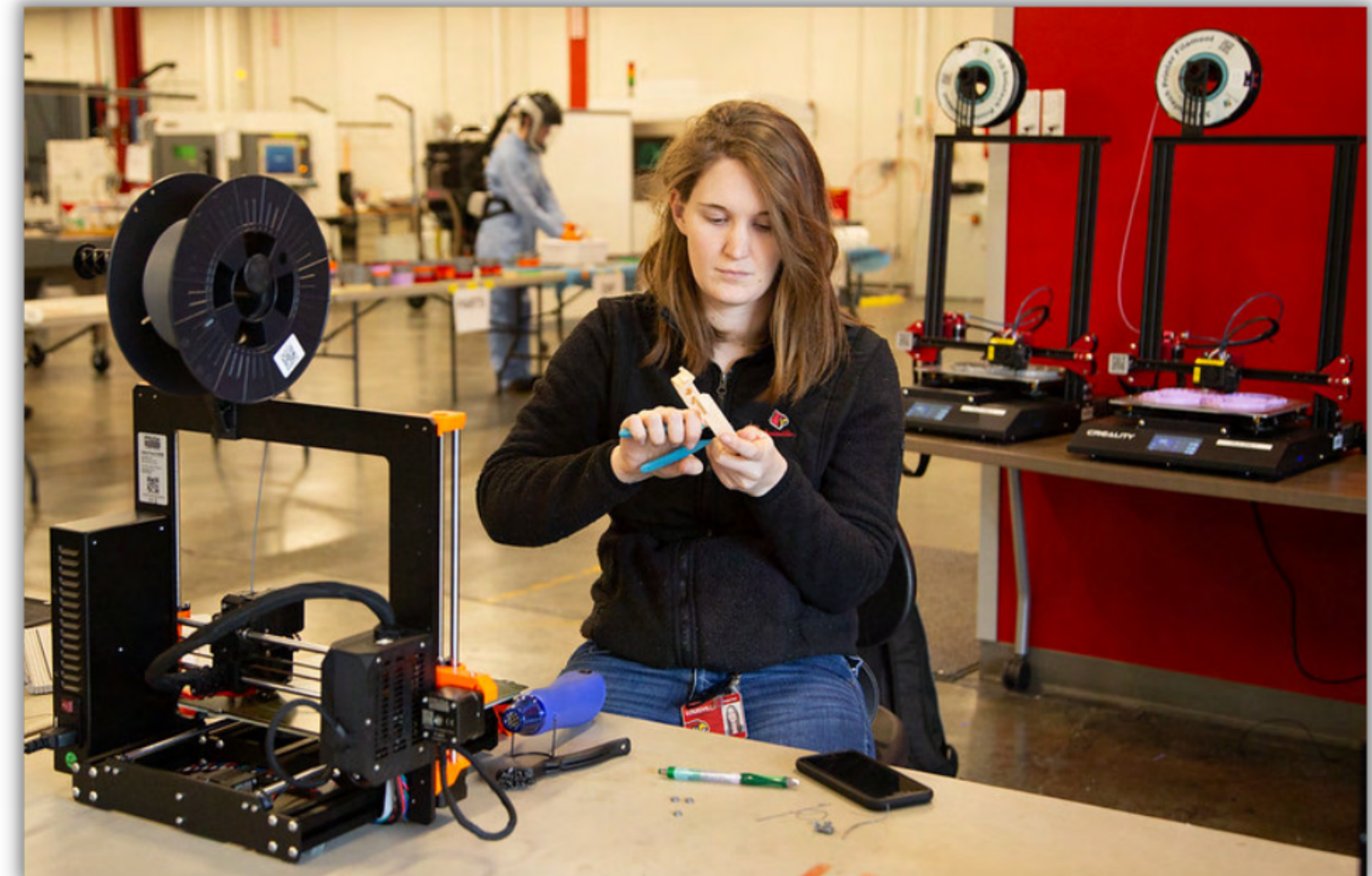



Feminist Social Justice Leadership

Belknap Village North

The Feminist Social Justice Leadership LLC is comprised of students who participate in structured learning experiences. Members of this residential community take two Cardinal Core classes together in the Department of Women's, Gender and Sexuality Studies and attend different workshops, lectures and activities hosted by WGST faculty and Women's Center staff throughout the year. Programming focuses on issues related to gender equity, social justice, feminism, and improving the status of women and LGBTQI+ individuals of all races, ethnicities, abilities and class backgrounds. The Feminist Social Justice Leadership community provides support in areas including academic engagement, mentor support, peer connection, and student involvement. In addition, the LLC assists students in developing relationships with faculty, staff, students and members of the local community who are involved in research, work and activism concerned with gender and sexual equity.



First Generation Cardinal

Belknap Village South

The First-Generation Cardinal Community provides first-generation students the unique opportunity to live in an inclusive environment that encourages their academic and personal success. By providing a support system and fostering a sense of belonging, students in this community will be able to successfully transition into college life. Participants will be able to live amongst and interact with other incoming first-generation students who are also beginning their higher education journey at the University of Louisville.





Honors

Kurz Hall

In partnership with the University Honors Program, the Honors LLCs are designed to create purposeful links among academic, residential, and social components of the university experience. Members of the LLCs live together and participate in group co-curricular activities. This shared academic involvement provides the foundation for the student's LLC experience. Living in the Honors LLCs provides several unique academic and social benefits including academic advising, on-site classes, and special opportunities for faculty, staff, and student interactions.





Parish

Belknap Village North

The Parish LLC welcomes students who are a part of or interested in learning more about Black culture and the various experiences among students in the African/Black diaspora. Its name symbolizing a community of a shared belief of academic excellence and cultural expression, this community offers students structured learning experiences through various courses using a cohort model. Students will also participate in the Cultural Center retention program where they will receive support in areas including academic engagement, personal and professional development, and mentor support. In addition, students in the living learning community will explore student involvement and gain leadership skills through various recognized student organizations affiliated with the Cultural Center.





Psychology

..... Kurz Hall

This LLC brings together students who want to pursue a career in psychology and prepare them for academic and personal success. This LLC focuses on helping students become connected to the department and the field of psychology, while simultaneously developing friendships with like-minded peers. Students will receive help in structuring their educational and extra-curricular experiences to put themselves in a position to find and pursue a fulfilling career in psychology





School of Music

Belknap Village South

This LLC encourages, engages, enhances, and supports the developments of the 21st-century musician. It offers students majoring in music the chance to interact with different groups on campus, to receive resources and support for skills and wellness issues related to musicians, and to explore entrepreneurial opportunities.

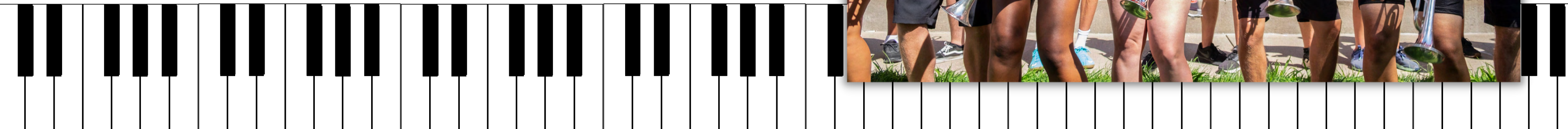



Social Work

Belknap Village South

In partnership with the Raymond A. Kent School of Social Work & Family Science, the Social Work LLC brings together students who want to pursue a career in social work and/or those who want to join a supportive community agents. The LLC focuses on academic engagement, mentor support, peer connections and student involvement. It will offer opportunities to develop a wide range of social, professional and community experiences



ULLC

UPPER-LEVEL
LIVING-LEARNING COMMUNITIES



Air Force ROTC & Army ROTC

University Tower Apartments

In partnership with the Army ROTC and Air Force ROTC, the ROTC LLC brings together students and cadets that are wishing to pursue a career in the Army or the Air Force. This residential community provides an opportunity build strong relationship with other cadets and get to engage together outside of ROTC-related events



Engineering

Bettie Johnson Hall



This LLC provides personal, academic, and professional support to first-year engineering students through various programs and activities throughout the year. As a member of the ELLC, you will have access to: On-site tutoring services for calculus, chemistry, and physics provided by Resources for Academic Achievement (REACH); Peer mentoring by a Speed School upperclassman, who holds weekly office hours in the ELLC residence hall and communicates regularly with ELLC members; Academic counseling by academic advisors, who hold weekly office hours in the ELLC residence hall; Engineering-based programming to improve study skills, explore careers, and network with peers and professionals; Social and wellness events.

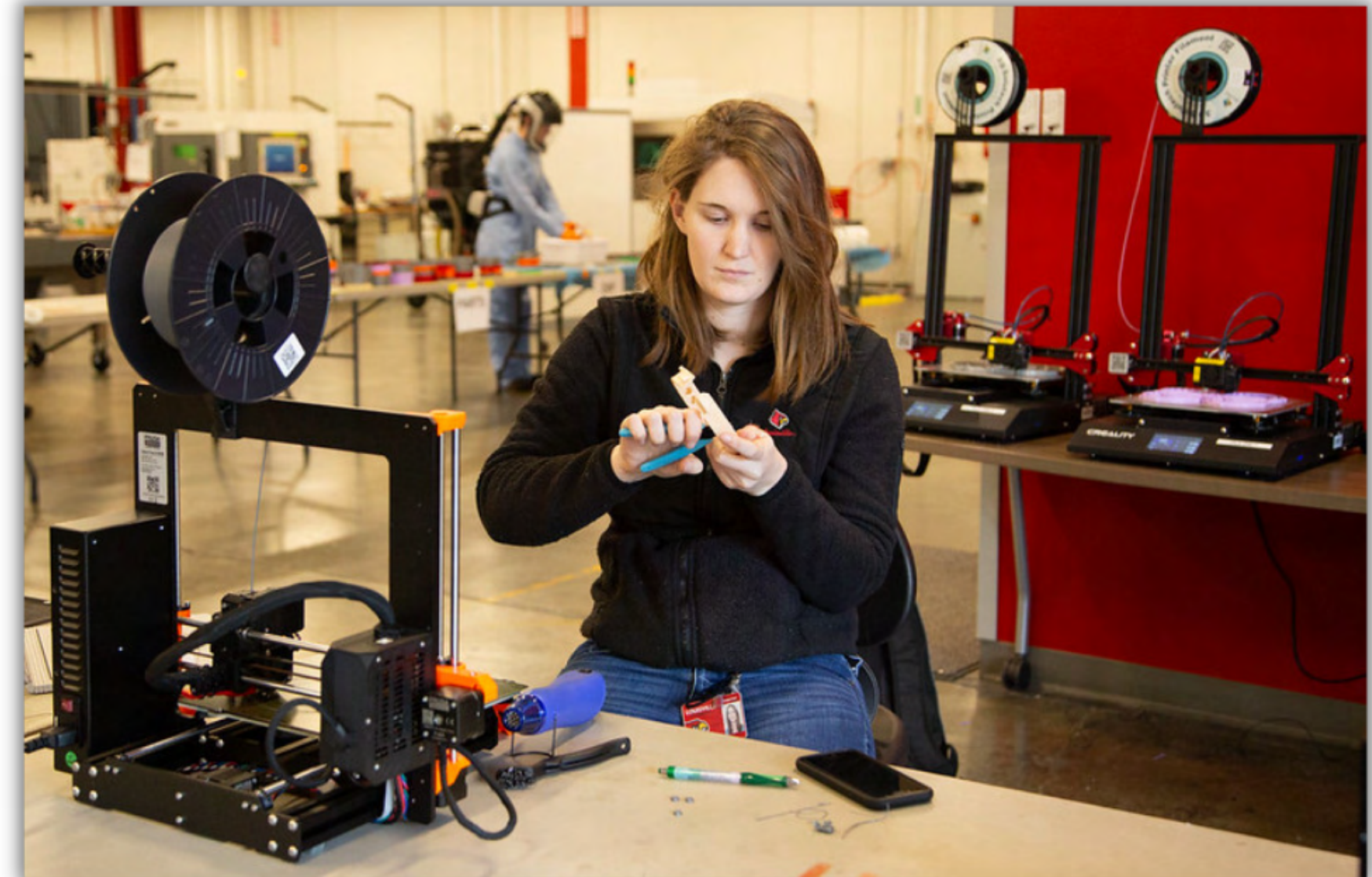

TC

FIRST-YEAR
THEMED COMMUNITIES



Bayard Rustin LGBTQ+ & Social Justice

Belknap Village North

Named after the gay civil rights activist Bayard Rustin, this TC welcomes students who want to learn more about and become allies of under-represented groups such as the LGBTQ+ community. Members of this community connect with faculty, staff, and campus partners committed to diversity and inclusion.



Ecology and Sustainability



University Tower Apartments

UofL's Sustainability Council and Biology department have partnered together to host a sustainability and natural world themed community. This community is perfect for students in the Biology BS, Ecology Track and students from any major who are interested in sustainability, including those majoring in Sustainability through the department of Urban and Public Affairs. Students in this themed community will have opportunities to cement the lessons of the classroom through practical application, service, and community building.



Esports

Bettie Johnson

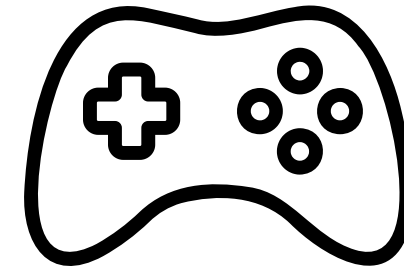

The Louisville Esports Themed Community (TC) is a direct association with the Cardinal Gaming RSO. The TC will help provide an inclusive and welcoming space for casual and competitive gamers to live collectively on campus. The TC will provide an outlet and home for individuals to seek a path into the competitive side of video games and will foster a better education from a structured residence hall environment. The competitive games in Cardinal Gaming are Overwatch, Rocket League, Smite, Paladins, CSGo, Call of Duty, Valorant, League of Legends, and Rainbow Six Siege. The casual games in Cardinal Gaming are Apex Legends, Paladins, Smash, Minecraft, Hearthstone, Fortnite, Legends of Runeterra, and many more.





Global Village

Bettie Johnson



The Global Village TC focuses on a residential experience that provides cross-cultural experiences, life-long friendships, and an opportunity to magnify global understanding. The purpose is to generate a more globally oriented and internationally connected campus community by adjoining intercultural dialogues and global context within the living and learning experience.

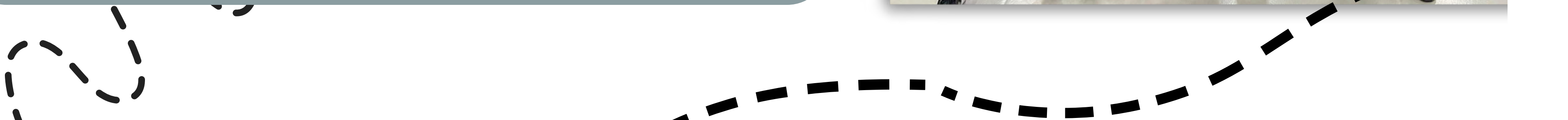

Metropolitan College

Kurz Hall

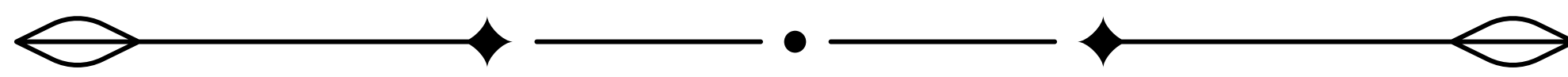

This Themed Community welcomes students who work third-shift at UPS as part of the Metropolitan College Program. This community provides students with a space in which to build relationships with their peers outside of the work environment and to share advice regarding time and sleep management, organization, and work-life balance.



TC

UPPER-LEVEL
THEMED COMMUNITIES



Bayard Rustin LGBTQ+ & Social Justice

Cardinal Towne Townhouse & University Tower Apartments

Named after the gay civil rights activist Bayard Rustin, this TC welcomes students who want to learn more about and become allies of under-represented groups such as the LGBTQ+ community. Members of this community connect with faculty, staff, and campus partners committed to diversity and inclusion.



Ecology and Sustainability



University Tower Apartments

UofL's Sustainability Council and Biology department have partnered together to host a sustainability and natural world themed community. This community is perfect for students in the Biology BS, Ecology Track and students from any major who are interested in sustainability, including those majoring in Sustainability through the department of Urban and Public Affairs. Students in this themed community will have opportunities to cement the lessons of the classroom through practical application, service, and community building.



Esports

Bettie Johnson

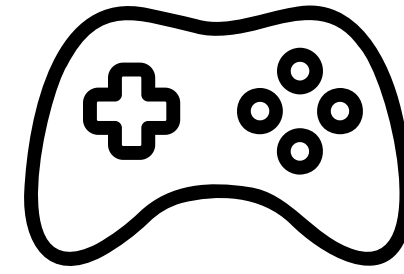

The Louisville Esports Themed Community (TC) is a direct association with the Cardinal Gaming RSO. The TC will help provide an inclusive and welcoming space for casual and competitive gamers to live collectively on campus. The TC will provide an outlet and home for individuals to seek a path into the competitive side of video games and will foster a better education from a structured residence hall environment. The competitive games in Cardinal Gaming are Overwatch, Rocket League, Smite, Paladins, CSGo, Call of Duty, Valorant, League of Legends, and Rainbow Six Siege. The casual games in Cardinal Gaming are Apex Legends, Paladins, Smash, Minecraft, Hearthstone, Fortnite, Legends of Runeterra, and many more.





Global Village

Bettie Johnson



The Global Village TC focuses on a residential experience that provides cross-cultural experiences, life-long friendships, and an opportunity to magnify global understanding. The purpose is to generate a more globally oriented and internationally connected campus community by adjoining intercultural dialogues and global context within the living and learning experience.

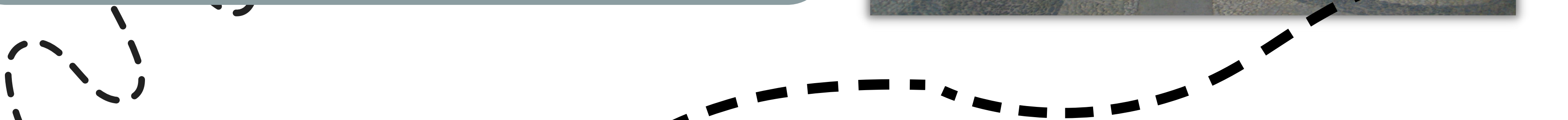

Metropolitan College

University Pointe

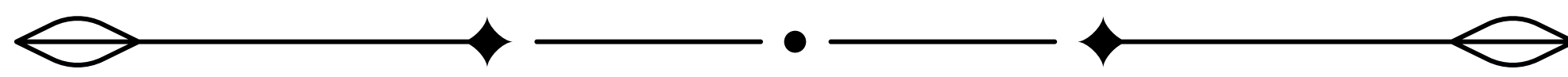

This Themed Community welcomes students who work third-shift at UPS as part of the Metropolitan College Program. This community provides students with a space in which to build relationships with their peers outside of the work environment and to share advice regarding time and sleep management, organization, and work-life balance.





Sport Professions

Denny Crum

In partnership with the Department of Health and Sport Sciences, the Sport Professions LLC is designed for students of ALL majors who are interested in working in sport and wellness industries. This community will help you “up your game” through networking with sport and wellness professionals in the Louisville community and beyond and professional development opportunities. Members of this community live in the same building, take classes together, and receive specialized programming focusing on professional development, careers in sport, and social engagement.

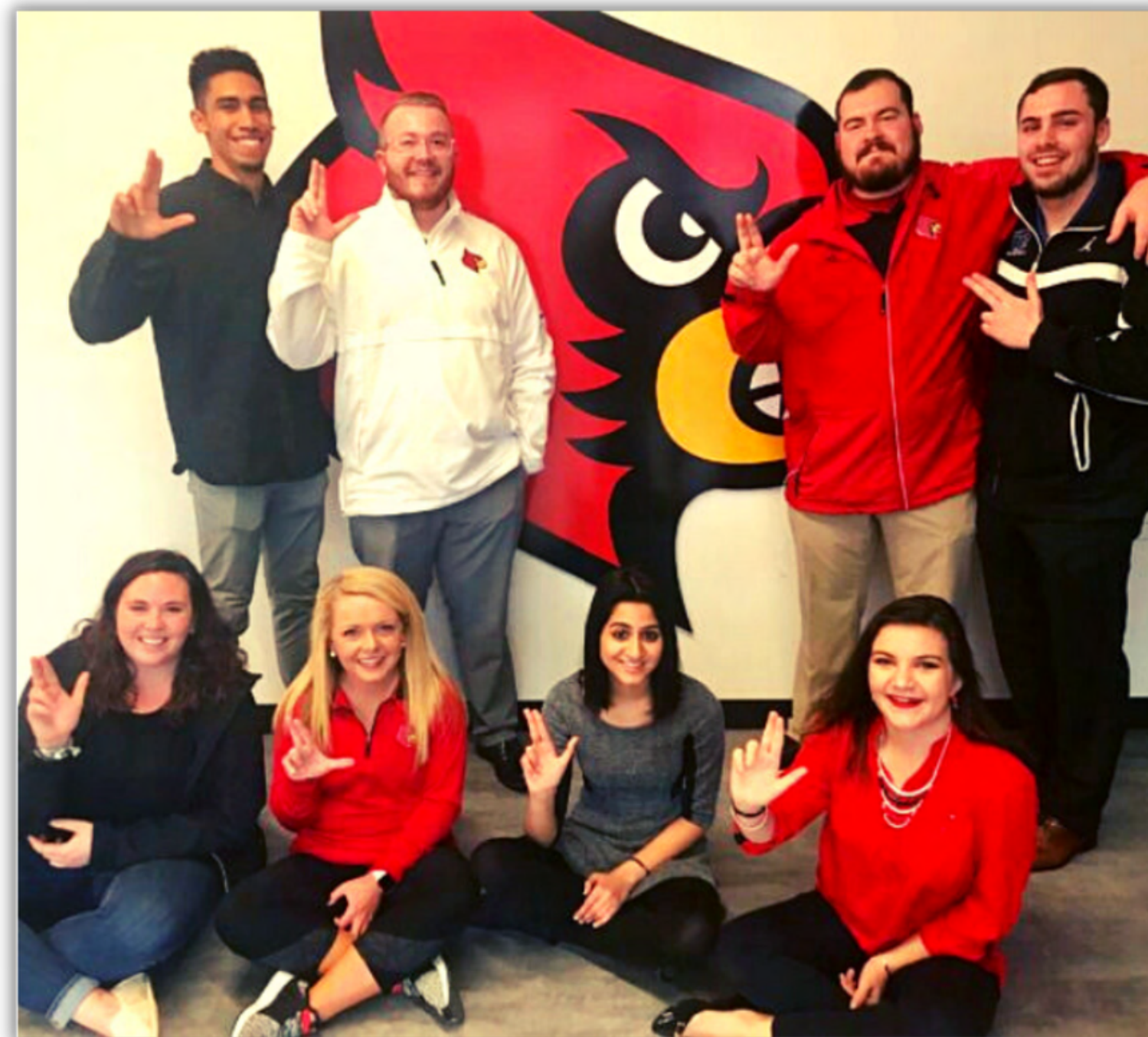

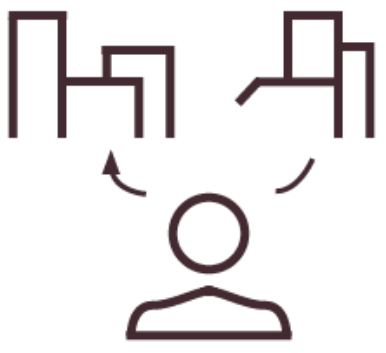

Transfer

Bettie Johnson

The Transfer TC tailors itself to transfer students at UofL. Members share their transfer experience and access timely resources as they acclimate to a new campus environment. This community prioritizes helping new Cardinals succeed at the university





Contact Us!

Social Media:

-  UofLHousing
-  UofL_Housing
-  UofL_Housing
-  UofLHousing
-  UofLHousing

Contact Information:

housing@louisville.edu

502-852-6636

Stevenson Hall

2024-2025

Living-Learning
Themed Communities