

# HOW TO REGISTER

After logging in to ULink, click on the tile labeled **Manage Classes**.

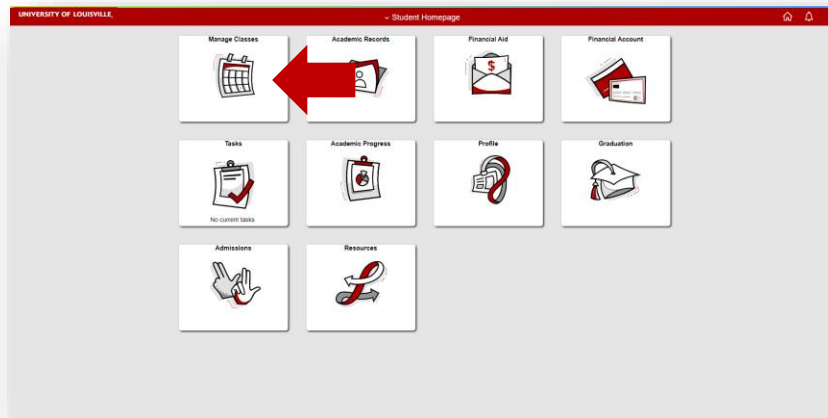

On the left sidebar, select **Class Search/Add to Cart**.

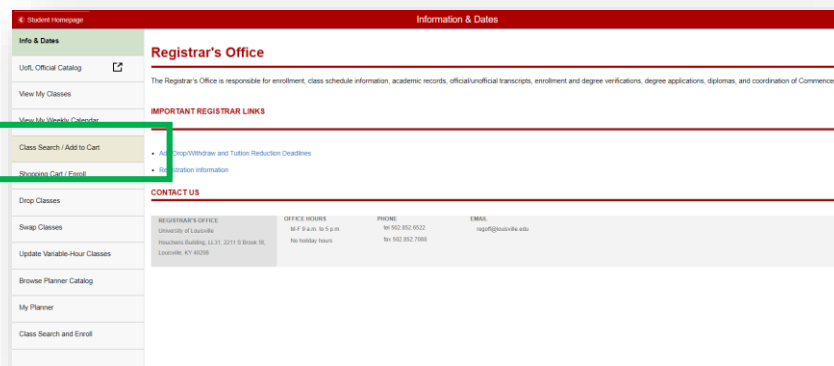

← Manage Classes

Fall 2023

Session  Subject  Catalog Nbr  Course Component  Degree Requirement  Gen Ed/Cardinal Core 1  And/Or

Location  Course Career  Catalog Nbr Wildcard  Class Number  Degree Requirement Value  Gen Ed/Cardinal Core 2

Open Classes Only  Honors Only  Meets Writing Requirement  Meets Any Gen Ed/Cardinal Core

No  No  No  No

Use the provided filters to narrow your search results. In the upper left corner of the screen you will see the term you are currently searching. If the term you wish to register in is not listed, click change, and select the correct term. Once you have made your selections, click **Search** to retrieve your results. If you wish to clear all of your options, click **Reset**.

# HOW TO REGISTER

Once your search results are returned, you can view class details by clicking the course label, listed in blue text, on the left. To add the course to your cart, click the **Add** button on the right.

Course	Title	Dates	Days and Times	Location / Room	Instructor(s)	Units	Current/Max Enrollment	
BIOL-104-02-LAB, #2744	Laboratory for Biology: Current Issues and Applications - SL Gen Ed: SL	01/09/23 - 05/02/23 Regular Full Term	Monday 10:00 AM to 11:50 AM	Belknap Campus / Belknap Academic Building 325	Stocke, Sanaya Kendall	1.00	Enrl: 0 of 24 Wait: 0 of 5	<b>Add</b>
BIOL-104-03-LAB, #2745	Laboratory for Biology: Current Issues and Applications - SL Gen Ed: SL	01/09/23 - 05/02/23 Regular Full Term	Monday 12:00 PM to 1:50 PM	Belknap Campus / Belknap Academic Building 325	Stocke, Sanaya Kendall	1.00	Enrl: 0 of 24 Wait: 0 of 5	<b>Add</b>
BIOL-104-04-LAB, #2747	Laboratory for Biology: Current Issues and Applications - SL Gen Ed: SL	01/09/23 - 05/02/23 Regular Full Term	Monday 4:00 PM to 5:50 PM	Belknap Campus / Belknap Academic Building 325	Stocke, Sanaya Kendall	1.00	Enrl: 0 of 24 Wait: 0 of 5	<b>Add</b>
BIOL-104-05-LAB, #2749	Laboratory for Biology: Current Issues and Applications - SL Gen Ed: SL	01/09/23 - 05/02/23 Regular Full Term	Monday 10:00 AM to 11:50 AM	Belknap Campus / Belknap Academic Building 328	Stocke, Sanaya Kendall	1.00	Enrl: 0 of 24 Wait: 0 of 5	<b>Add</b>
BIOL-104-07-LAB, #2749	Laboratory for Biology: Current Issues and Applications - SL Gen Ed: SL	01/09/23 - 05/02/23 Regular Full Term	Monday 12:00 PM to 1:50 PM	Belknap Campus / Belknap Academic Building 328	Stocke, Sanaya Kendall	1.00	Enrl: 0 of 24 Wait: 0 of 5	<b>Add</b>
BIOL-104-08-LAB, #2750	Laboratory for Biology: Current Issues and Applications - SL Gen Ed: SL	01/09/23 - 05/02/23 Regular Full Term	Monday 4:00 PM to 5:50 PM	Belknap Campus / Belknap Academic Building 328	Stocke, Sanaya Kendall	1.00	Enrl: 0 of 24 Wait: 0 of 5	<b>Add</b>

You can continue to refine your results by using the provided checkboxes located on the left sidebar of your screen. The number in parenthesis represents the number of classes available for that specific selection.

- Class Status**
  - Open (137)
  - Closed (1)
- Location**
  - Belknap Campus (138)
- Instruction Mode**
  - In Person (138)
- Class Component**
  - Laboratory (67)
  - Lecture (46)
  - Recitation (12)
  - Ind Study (11)
  - Seminar (2)
- Subject**
  - BIOL / Biology (138)
- Community Based Learning**
  - Capstone (12)
  - Service Learning (10)
  - Research (9)

# HOW TO REGISTER

If you would like to delete a class from your selection place a checkmark in the space provided on the right side of your screen. After designating the course(s) you want to remove, click **Delete**.

If you are satisfied with your choices, and are ready to view your cart, click **Go to Cart** or use the Blackboard & Follett links to verify course materials.

Once viewing your Shopping Cart you will see your selection of classes. You will have the option to **Enroll, Delete, or Validate** the classes you have placed in the cart. **Enrolling** in the course will register you, **Delete** will remove the course from your Shopping Cart, and **Validate** will confirm you have met any prerequisites for the selected course.

**BIOL 329 - CELLULAR-MOLECULAR BIOL**  
Availability Open

01 (# 2762) - Lecture  
Seats Open Seats 60 of 60  
Units 3.00  
Days Tuesday Thursday  
Times 4:00PM to 5:15PM  
Room Belknap Academic Building 125  
Instru... M. Abolins-Abols

**COMM 327 - EFFECTS OF MASS MEDIA**  
Availability Open

50 (# 7173) - Lecture  
Seats Open Seats 30 of 30  
Units 3.00  
Sche... To be Announced  
Room Distance Educ  
Instru... - TBA

**COMM 333 - SOCIAL MEDIA**  
Availability Open

Your Shopping Cart

Select	Availability	Section (Class#)	Description	Session	Days and Times	Room	Instructor	Units	Seats	Preferences
<input type="checkbox"/>	Open	40 (# 7948) - Lecture	ACCT 201 PRIN OF FIN ACCT	Regular Full Term	To be Announced	Distance Educ	D. Bell	3.00	Open Seats 16 of 25	<a href="#">Change Preferences</a>
<input type="checkbox"/>	Open	04 (# 2747) - Laboratory	BIOL 104 BIOL APPLICATIONS - SL	Regular Full Term	Monday 4:00PM to 5:50PM	Belknap Academic Building 325	S. Stocke	1.00	Open Seats 5 of 24	<a href="#">Change Preferences</a>
<input type="checkbox"/>	Open	12 (# 2753) - Laboratory	BIOL 104 BIOL APPLICATIONS - SL	Regular Full Term	Tuesday 2:30PM to 4:20PM	Belknap Academic Building 325	S. Stocke	1.00	Open Seats 14 of 24	<a href="#">Change Preferences</a>

# HOW TO REGISTER

Once you have made your selections you can enroll in a class by placing a checkmark in the box for the respective course. A pop-up window will appear asking you to confirm your selection.

**Your Shopping Cart** Enroll

Select	Availability	Section (Class#)	Description	Session	Days and Times	Room	Instructor	Units	Seats
<input type="checkbox"/>	Open	40 (# 7948) - Lecture	ACCT 201 PRIN OF FIN ACCT	Regular Full Term	To be Announced	Distance Educ	D. Bell	3.00	Open Seats 16 of 25
<input checked="" type="checkbox"/>	Open	04 (# 2747) - Laboratory	BIOL 104 BIOL APPLICATIONS - SL	Regular Full Term	Monday 4:00PM to 5:50PM	Belknap Academic Building 325	S. Stocke	1.00	Open Seats 5 of 24
<input type="checkbox"/>	Open	12 (# 2753) - Laboratory	BIOL 104 BIOL APPLICATIONS - SL	Regular Full Term	Tuesday 2:30PM to 4:20PM	Belknap Academic Building 325	S. Stocke	1.00	Open Seats 14 of 24
<input type="checkbox"/>	Open	02 (# 3055) - Laboratory	BIOL 258 INTRO MICROBIOLOGY - SL	Regular Full Term	Monday 10:00AM to 11:50AM	Life Sci 217	P. Himes	1.00	Open Seats 12 of 24
<input type="checkbox"/>	Closed	01 (# 2762) - Lecture	BIOL 329 CELLULAR-MOLECULAR BIOL	Regular Full Term	Tuesday Thursday 8:00PM to 5:15PM	Belknap Academic Building 131	M. Abolins-Abols	3.00	Closed

Are you sure you want to enroll?

You will receive a confirmation message to notify you the course has been added to your schedule.

✓ **COMM 201 - Introduction to Communication - SB**  
This class has been added to your schedule.  
[View Holds/To Do List.](#)