

Research MRI at UofL

Siemens 3 Tesla MRI (Skyra)



Department of Radiology

HSC Instr. Bld B, LL17

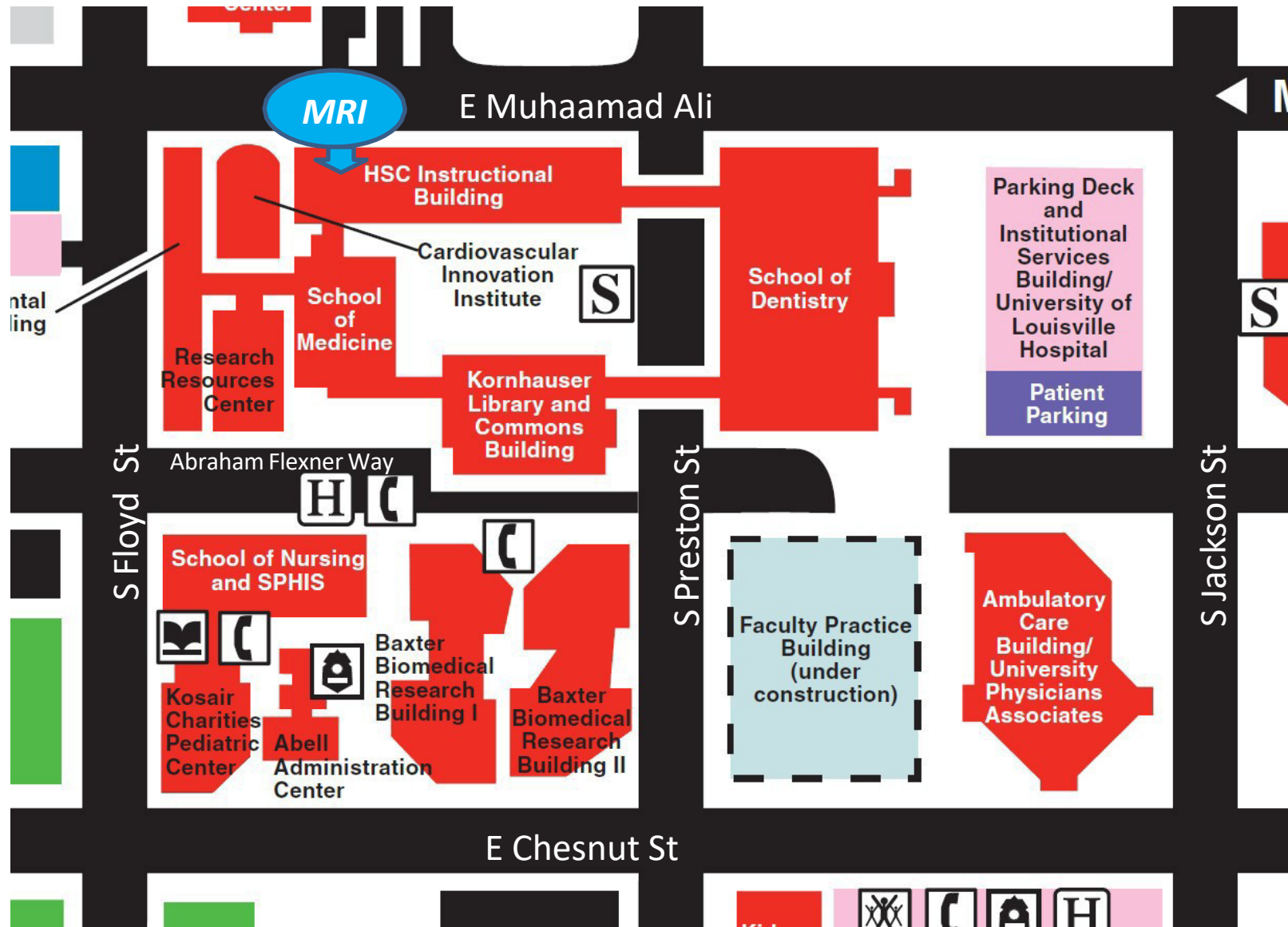

Floor Plan

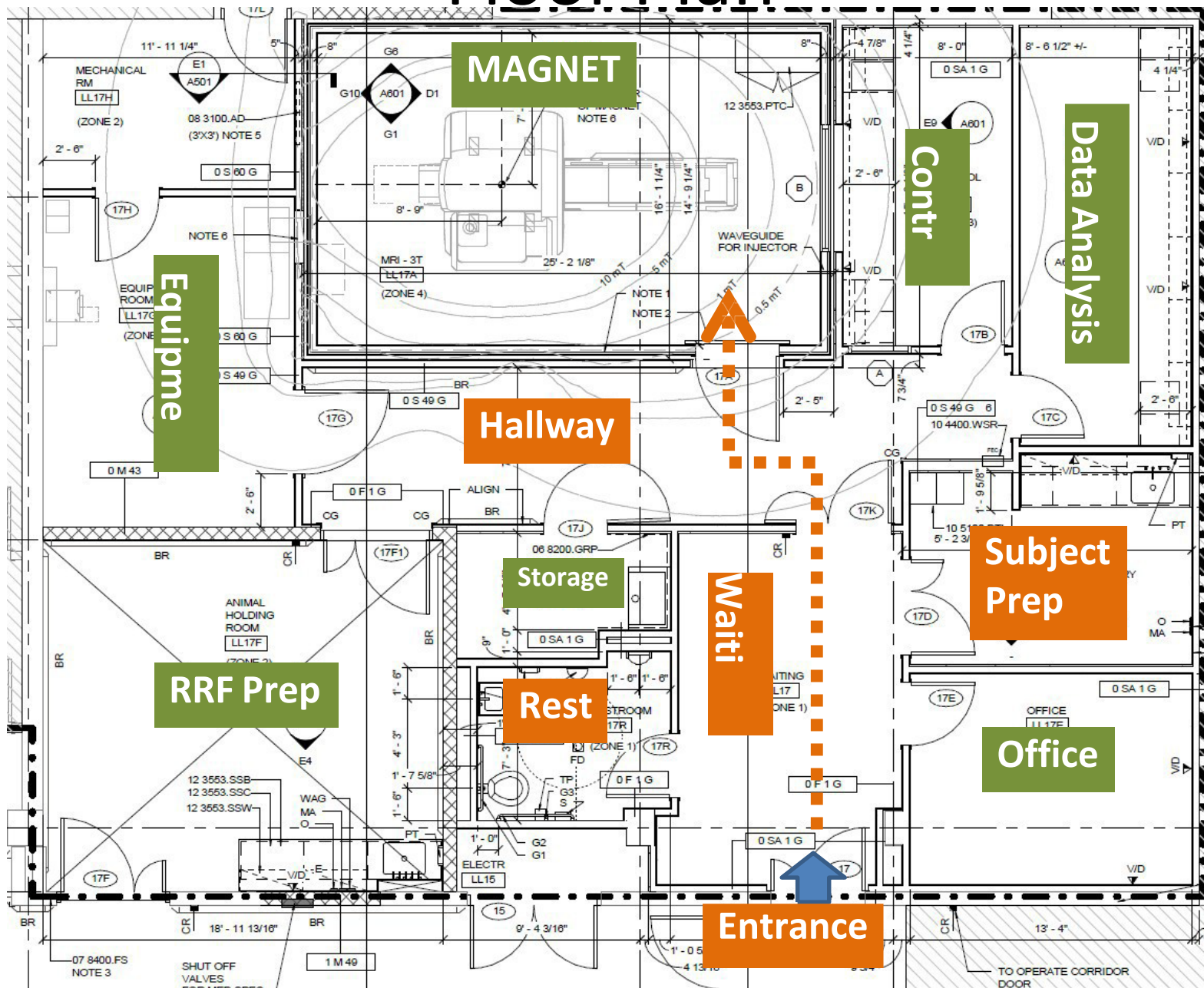

Magnet Room



Control Room



Waiting Room and Entry to Magnet Room



Preparation Room







View from the waiting room

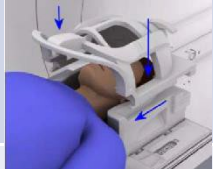

View from the preparation room

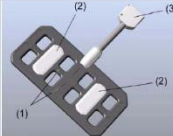
RF and Gradient Coils

Name	Manufacturer	Description
Head and neck	Siemens	20 ch 
Spine	Siemens	32 ch 
Knee	Siemens	15 ch
Body array	Siemens	18 ch 
Large flexible	Siemens	4 ch 
Small flexible	Siemens	4 ch 
Gradient	Siemens	Amplitude=45 mT/m, Slew rate=200T/m/s ₈ 

Ancillary Equipment

Equipment	Manufacturer	Model
Image analysis	Siemens	MMWP (Cardiac, Spectroscopy, fMRI, DWI)
Physiology monitor	Invivo	Precess (EKG, SPO2, BP)
fMRI stimuli	Invivo	Esys (LCD TV, Stereo audio)
fMRI program	PST	ePrime 1 and 2
fMRI response	Cedrus	Lumina (2 buttons of both hands)
Contrast agent injector	Medrad	Spectra Solaris
Anesthesia	DRE	Premier XP (Control of breath hold)
File server	Microway	6TB

MR FACILITY UTILIZATION RATE (effective 7/1/2022)

- MR Facility Utilization rate for Fiscal Year 2023 (07/01/2022 – 06/30/2023) is \$625 per facility hour; MR Facility Utilization is based upon total room time *with a 30 minute minimum* (including Set-Up: Scan Start: Scan Stop: Clean-Up).
- For multi-year grants / projects, see budget forecasting section below

Budget forecasting:

For all active grants, contracts, projects / programs including new submission, continuations, renewals, and no cost extensions, please budget a 5% increase in the MR Research Facility Utilization Rate per fiscal year (Fiscal Year over Fiscal Year); ie. Fiscal Year 2024 (starting July 01, 2024) MR facility utilization rate should be budgeted at \$656 per facility hour and Fiscal Year 2025 should be budgeted at \$689 per facility hour with a 5% increase budgeted per fiscal year going forward.

Scan Policy

- Management and Operation
 - Chin K. Ng, Ph.D., Vice-Chair for Translational Research, Department of Radiology, chin.ng@Louisville.edu
 - MR Scientist: MJ Negahdar, Ph.D.
- Consulting and scheduling
 - Email: mj.negahdar@louisville.edu
 - Tel: 502-852-6423