

- LEGEND**
- Park Drive
 - Boulevard
 - Community Street
 - Neighborhood Street
 - Commercial Street
 - Alley
 - Existing Street Rebuilt

The Legend above outlines all new street construction except the final category *Existing Street Rebuilt*. In this instance the existing street is to be removed and a new street constructed to the same grades and lines as the existing, adjusting for proposed new widths and right-of-ways. Rebuilt streets will have new curbs, new paving surface (using existing subgrades and subbase where appropriate), new sidewalks, street lighting and street trees. New utilities will be constructed as required.

Park DuValle Hope VI Conceptual Master Plan

Public Improvements Plan

Prepared for the Housing Authority of Louisville and the City of Louisville



Urban Design Associates
LaQuatra Bonci Associates

March 1998

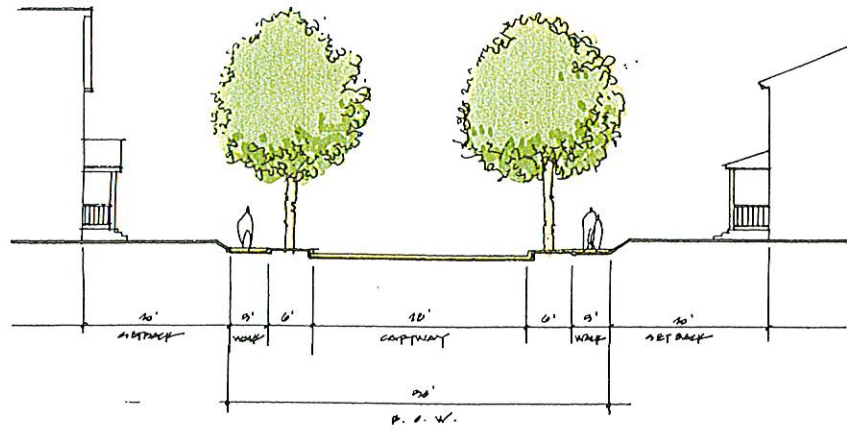

Neighborhood Street Section

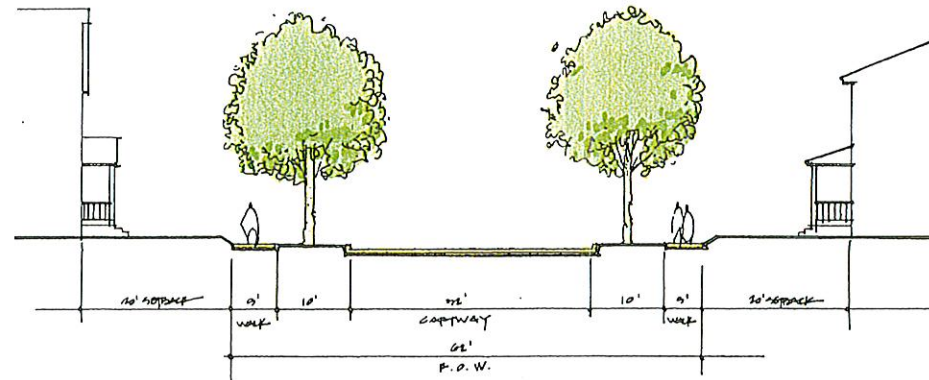

Community Street Section

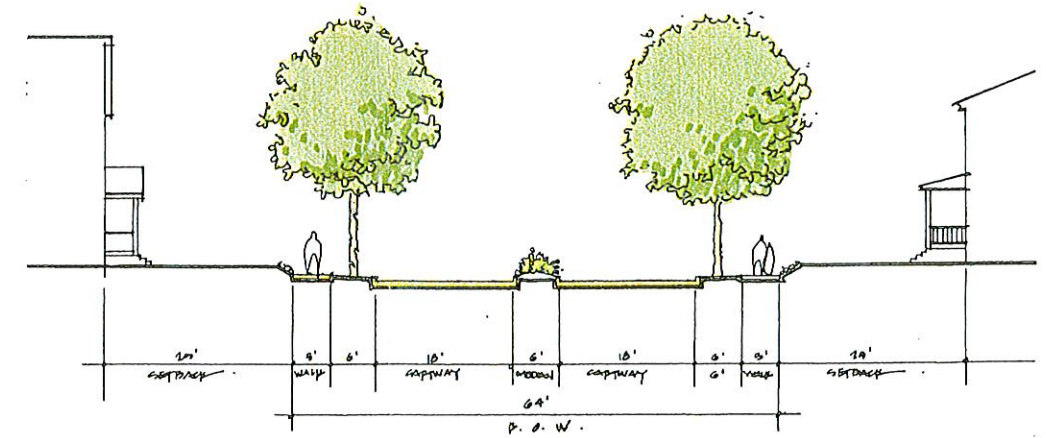

Boulevard Street Section

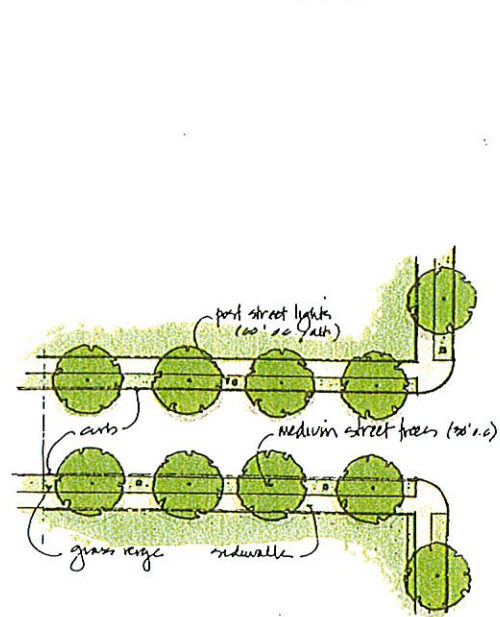

Neighborhood Street Plan

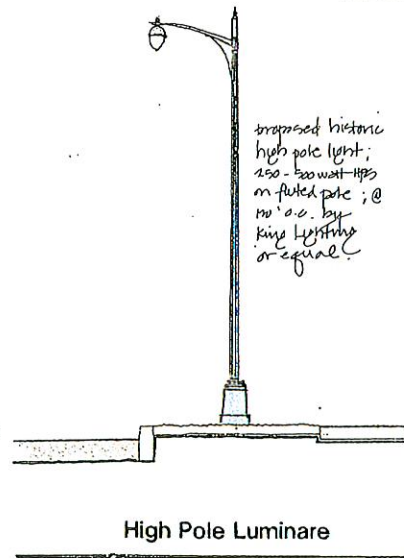

High Pole Luminaire

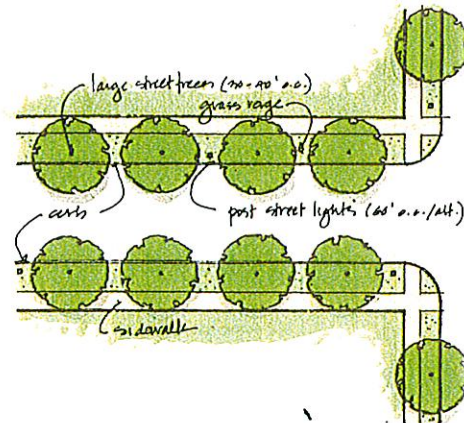

Community Street Plan

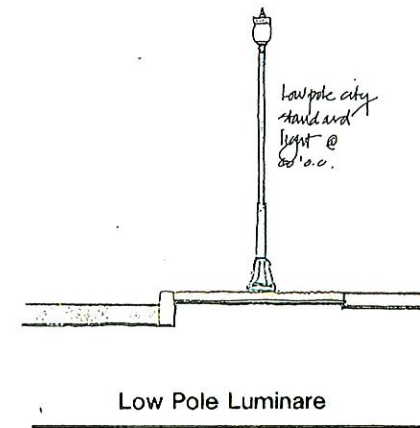

Low Pole Luminaire

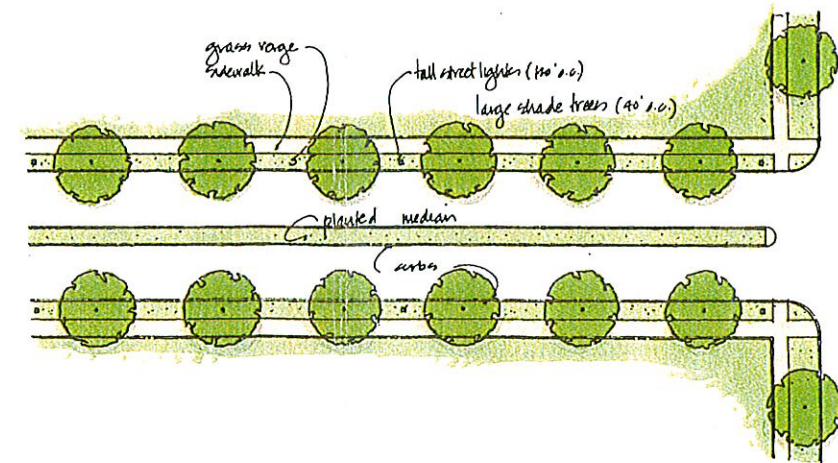

Boulevard Street Plan

Park DuValle Hope VI Conceptual Master Plan

Public Improvements Detail Plan and Street Sections

Prepared for the Housing Authority of Louisville and the City of Louisville

Urban Design Associates
LaQuatra Bonci Associates

March 1998