

## BELKNAP ACADEMIC BUILDING CLASSROOM OVERVIEW

Review this document for classroom configurations and equipment available throughout the Belknap Academic Building. This document does not include lab layouts and equipment.

### FLOOR 1

#### ROOM 125

- 60 SEATS
- 2 PROJECTORS
- 1 INSTRUCTOR DISPLAY
- 2 CONTROL PANELS
- 1 INSTRUCTOR MIC
- 6 STUDENT DISPLAYS
- 9 POWER TOWERS

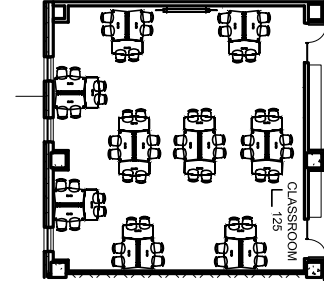

#### ROOM 128

- 99 SEATS
- 2 PROJECTORS
- 2 INSTRUCTOR DISPLAYS
- 2 CONTROL PANELS
- 1 INSTRUCTOR MIC
- 33 STUDENT DISPLAYS
- 33 STUDENT MICs

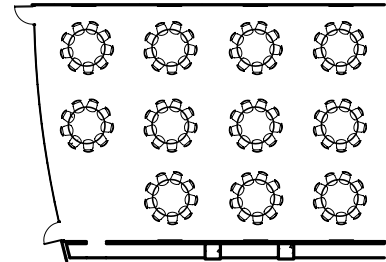

#### ROOM 129

- 124 SEATS
- 2 PROJECTORS
- 2 INSTRUCTOR DISPLAYS
- 2 CAMERAS
- 2 CONTROL PANELS
- 1 INSTRUCTOR MIC
- 38 STUDENT DISPLAYS
- 28 STUDENT MICs

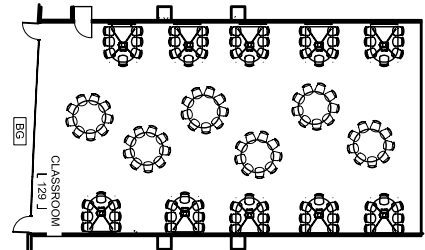

#### ROOM 130

- 95 SEATS
- 2 PROJECTORS
- 2 INSTRUCTOR DISPLAYS
- 2 CAMERAS
- 2 CONTROL PANELS
- 1 INSTRUCTOR MIC
- 9 STUDENT DISPLAYS
- 9 STUDENT MICs
- 4 POWER TOWERS

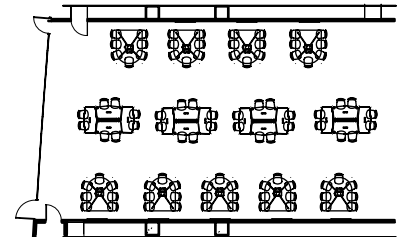

#### ROOM 131

- 66 SEATS
- 2 PROJECTORS
- 2 INSTRUCTOR DISPLAYS
- 2 CAMERAS
- 2 CONTROL PANELS
- 1 INSTRUCTOR MIC
- 8 STUDENT DISPLAYS
- 28 STUDENT MICs
- 11 POWER TOWERS

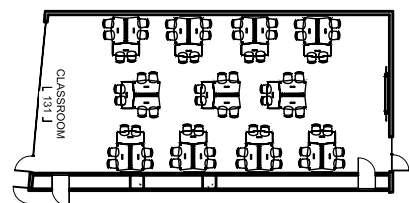

## FLOOR 2

### ROOM 224

- 16 SEATS
- 1 INSTRUCTOR DISPLAY

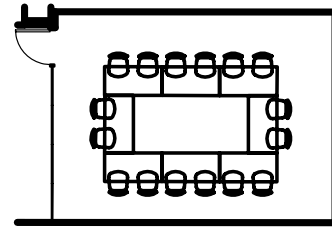

### ROOMS 225, 226, 227

- 60 SEATS
- 2 PROJECTORS
- 1 CONTROL PANEL
- 1 INSTRUCTOR MIC
- 10 STUDENT DISPLAYS

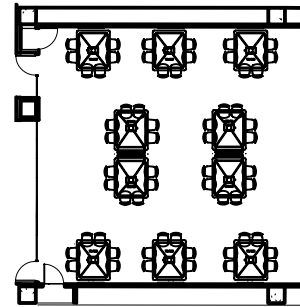

### ROOM 239A

- 32 SEATS
- 1 PROJECTORS
- 1 CONTROL PANEL
- 1 INSTRUCTOR MIC
- 3 STUDENT DISPLAYS
- 4 POWER TOWERS

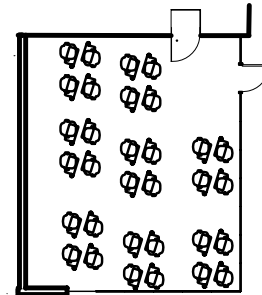

### ROOM 239B

- 24 SEATS
- 1 PROJECTOR
- 1 CONTROL PANEL
- 1 INSTRUCTOR MIC
- 4 STUDENT DISPLAYS
- 4 POWER TOWERS

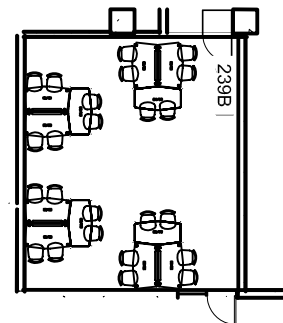

### ROOM 233, 234, 235

- 48 SEATS
- 2 PROJECTORS
- 2 INSTRUCTOR DISPLAYS
- 1 CONTROL PANEL
- 1 INSTRUCTOR MIC
- 8 STUDENT DISPLAYS
- 6 POWER TOWERS

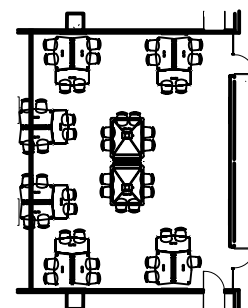

## FLOOR 3

### ROOM 307, 335, 336

- 16 SEATS
- 1 INSTRUCTOR DISPLAY

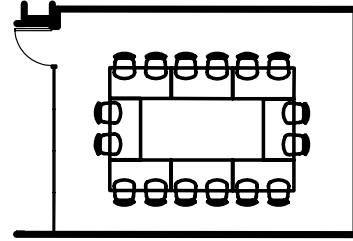

## FLOOR 4

### ROOM 408, 409

- 36 SEATS
- 1 PROJECTOR
- 1 CONTROL PANEL
- 1 INSTRUCTOR MIC
- 6 STUDENT DISPLAYS
- 6 POWER TOWERS

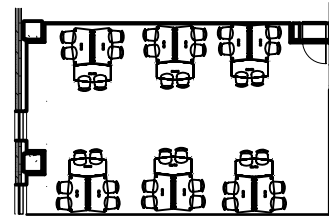

### ROOM 410A, 410B

- 16 SEATS
- 1 CONTROL PANEL
- 1 INSTRUCTOR MIC
- 4 STUDENT DISPLAYS
- 4 POWER TOWERS

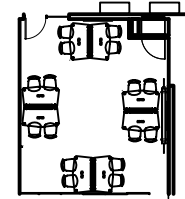

### ROOM 412

- 40 SEATS
- 1 PROJECTORS
- 1 CONTROL PANEL
- 1 INSTRUCTOR MIC
- 5 STUDENT DISPLAYS
- 5 POWER TOWERS

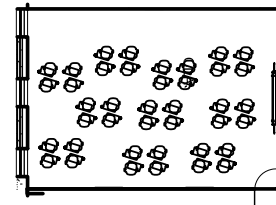

### ROOM 413, 414

- 30 SEATS
- 1 PROJECTOR
- 1 CONTROL PANEL
- 1 INSTRUCTOR MIC
- 5 STUDENT DISPLAYS
- 5 POWER TOWERS

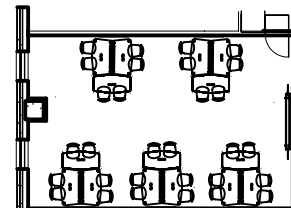

### ROOM 406, 427, 428

- 16 SEATS
- 1 INSTRUCTOR DISPLAY

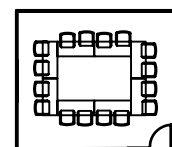

## EQUIPMENT

---

### THE FOLLOWING ARE PROVIDED IN ALL CLASSROOMS (UNLESS INDICATED)

- SPEAKERS (WITH THE EXCEPTION OF 410A AND 410B)
- ASSISTIVE LISTENING DEVICES
- WALL POWER OUTLETS AND POWER TOWERS (WHERE INDICATED)
- WHITEBOARDS IN ALL CLASSROOMS
- HUDDLEBOARDS ARE AVAILABLE IN CLASSROOMS WITH MOVABLE CONFIGURATIONS
- HUDDLEBOARD RAILS (EXCEPT ROOMS 410A AND 410B)



Huddleboard



Huddleboards on Huddleboard Rail