

# CENTRAL AND SOUTHERN GSA/OSR JOINT REGIONAL MEETING

In Partnership with



**AAMC**

Tomorrow's Doctors, Tomorrow's Cures®

## NAVIGATING EVOLVING PATHWAYS



**OMNI LOUISVILLE HOTEL  
LOUISVILLE, KY  
APRIL 12—APRIL 14, 2019**



**WE WISH TO RECOGNIZE THESE SCHOOLS FOR GENEROUS SUPPORT OF THE MEETING:**

**UNIVERSITY OF LOUISVILLE SCHOOL OF MEDICINE | MICHIGAN STATE UNIVERSITY COLLEGE OF HUMAN MEDICINE  
THE OHIO STATE UNIVERSITY COLLEGE OF MEDICINE | UNIVERSITY OF TEXAS – SOUTHWESTERN MEDICAL SCHOOL  
WAKE FOREST UNIVERSITY SCHOOL OF MEDICINE**

## MEETING SCHEDULE

Thursday, April 11, 2019		
1:00–5:00	<b>Pre-Conference Workshop—GSA Professional Development Initiative: Guiding Struggling Students Toward Success</b> Presenters: Michael Kavan, Tammy Salazar	MALT
Friday, April 12, 2019		
7:00–5:00	<b>Onsite Registration</b>	COMMONWEALTH 1/2/3 PRE-FUNCTION AREA
7:30–8:30	<b>GSA Welcome and Breakfast</b> (Joint Central and Southern) Regional chairs: Joel Maurer and Angela Mihalic GSA National Chair Elect: Anita Pokorny	COMMONWEALTH 1/2/3/4
7:30–8:30	<b>OSR Business Meeting and Breakfast</b> (Joint Central and Southern)	OLMSTED 5/6/7
8:30–8:45	<b>BREAK</b>	
8:45–8:55	<b>Welcome from University of Louisville School of Medicine</b> Dean Toni M. Ganzel, MD, MBA, FACS	COMMONWEALTH 6/7/8
8:55–9:00	<b>Welcome from AAMC Leadership</b> Diana Bourke, Chief Operating Officer, AAMC	
9:00–10:15	<b>Plenary I: Building Personal Resilience</b> Presenter: Michael Wiederman, PhD	
10:15–10:30	<b>BREAK</b>	
10:30–11:45	<b>Breakout Session 1</b>	
	<b>AAMC Update–SJT Update</b>	CRESCENT HILL
	<b>Birds of a Feather—Student Diversity Affairs</b> Facilitators: C. Alexander Grieco, Linda Strong James	HIKES POINT
	<b>Birds of a Feather—General Student Affairs</b> Facilitators: Joel Maurer, Angela Mihalic	OLMSTED 5/6/7
	<b>Innovative Secondary Applications: How Portfolios and Video Interviews will Transform Your Admissions Process</b> Presenters: Heather D. Wright, Nora Few	NULU
	<b>Building Community: Hear examples and brainstorm with other students on ways to enhance student support at your school</b> Presenters: Zoetta L. Hildreth, Olivia Chase	OLD LOUISVILLE
	<b>Effective Practices for Developing Policies on Good Standing</b> Presenters: Teresa Cook, Alisha Corsi, Susan Schmidt	CHEROKEE TRIANGLE
	<b>Incorporating Business and Leadership Training into Medical School Education to Prepare Tomorrow’s Doctors for the Continually Evolving Healthcare Enterprise</b> Presenters: Jamaal Richie, Kevin R. Kwan, Brad Sutton, In Kim	GERMANTOWN
11:45–1:30	<b>Lunch and Table Topic Discussions with GSA and OSR</b> Facilitator: Aurora Bennett	COMMONWEALTH 1/2/3/4
1:30–1:45	<b>BREAK</b>	
1:45–3:00	<b>Breakout Session 2</b>	
	<b>AAMC Update: Student Affairs Programs</b> Presenters: Brandon Hunter and Amy Addams	OLMSTED 5/6/7
	<b>Promoting Student Success: Supporting Acclimation through a Novel Curricular Element (Workshop)</b> Presenters: Stacy Schmauss, Marcia Wofford	HIKES POINT
	<b>Enrollment Management in Medical Schools: Using Data to Drive Effective Decision Making</b> Presenters: Christina Grabowski, Steven Gay	CRESCENT HILL

Friday, April 12, 2019 (continued)		
1:45–3:00	<b>Breakout Session 2 (continued)</b>	
	<b>Ensuring Success through Individualized Performance Improvement Plans</b> Presenter: Leah Robinson	NULU
	<b>Taking a Detour: Supporting Leave of Absence and Non-Traditional Students from Matriculation to Graduation</b> Presenters: Taylor Bono, Nicholas Van Wagoner, T. Alexander Edgil	OLD LOUISVILLE
	<b>Innovations and Emerging Issues in the Match: TexasSTAR and participation of osteopathic students</b> Presenters: Kathleen Kashima, Angela P. Mihalic, Anita Pokorny, Kim Peck	GERMANTOWN
	<b>Mistreatment as a Medical Student: How to Recognize It and What to Do</b> Presenters: Graham Husband, Jordan Jensen	CHEROKEE TRIANGLE
3:00–3:15	<b>BREAK with Snacks</b>	COMMONWEALTH PRE-FUNCTION AREA
3:15–4:45	<b>Breakout Session 3</b>	
	<b>AAMC MCAT Update</b> Presenters: Cindy Searcy, Ying Jin, Joshua Hansen (moderator)	HIKES POINT
	<b>ERAS and NRMP Update</b> Presenters: Amy Mathis, Juliann Winn, Mona Signer	OLMSTED 5/6/7
	<b>Apples &amp; Oranges: Challenges of Ensuring Comparable Student Service Experiences across Regional Medical Campuses</b> Presenters: Corey Koperski, Joseph Drazkowski, Lanita Carter, Kathryn Martin	CRESCENT HILL
	<b>“Am I really qualified to be here?” Exploring the impact of Imposter Syndrome on training and careers in medical education</b> Presenters: Kateena Addae-Konadu, Sonia Carlson, Alexandra Castillejos, Alyssa Stephenson-Famy, Kimberly Gecki	NULU
	<b>FERPA: What the Registrar Needs You to Know!</b> Presenters: Barbara Gadzinski, Teresa Cook, Matt Edwards	OLD LOUISVILLE
	<b>Taking Education to the Next Level: Utilizing Tutors to Improve Tutoring</b> Presenters: Kristin Richey, Antwione Haywood, Abigail F. Klemsz, Jason Hoard	CHEROKEE TRIANGLE
5:00–6:15	<b>Movie: <i>Rubbertown</i>—a documentary examining a neighborhood of heavy industrial manufacturing plants and the effect on residents followed by discussion</b> Discussant: Aruni Bhotnagar, Ph.D.	COMMONWEALTH 6/7/8
6:30	<b>Dine-Around Dinner or Dinner on Your Own</b> Information/Sign-up at Registration Desk	
<b>Saturday, April 13, 2019</b>		
7:00–5:00	<b>Onsite Registration</b>	COMMONWEALTH 1/2/3 PRE-FUNCTION AREA
7:30–9:00	<b>CGSA Business Meeting with Breakfast</b>	COMMONWEALTH 6/7/8
7:30–9:00	<b>SGSA Business Meeting with Breakfast</b>	COMMONWEALTH 1/2/3/4
7:30–9:00	<b>OSR (Joint Central and Southern) Business Meeting with Breakfast</b> <i>Including a welcome from AAMC Leadership—Diana Bourke, Chief Operating Officer, AAMC</i>	OLMSTED 5/6/7
9:00–9:15	<b>BREAK</b>	
9:15–10:30	<b>Breakout Session 4</b>	
	<b>Birds of a Feather—Admissions</b> Presenters: Joel Maurer, Doug Taylor	HIKES POINT
	<b>AAMC Update—State of Education Debt and Student Loan Repayment Options</b> Presenter: Kristen Earle	CRESCENT HILL

<b>Saturday, April 13, 2019 (continued)</b>			
9:15–10:30	<b>Breakout Session 4 (continued)</b>		
	<b>Navigating the Pathways for Learners with Disabilities–The AAMC/UCSF Report (Panel)</b> Presenters: Lisa M. Meeks, Lina Mehta, Charlotte O’Conner, Nicole Taylor, Samantha Schroth, Molly Fausone, Hilit F. Mechaber		GERMANTOWN
	<b>Effectiveness of Student-Led Initiatives to Improve Medical Student Wellness</b> Presenters: Komal S. Safdar, Alper Dincer, Wei-Li Suen, Nicole M. Deiorio, Christopher Woleben		NULU
	<b>AAMC Twitter Bootcamp</b> Presenters: Benjamin Vega, Abdoulie Njai, Aaron D. Gray		OLD LOUISVILLE
	<b>Promoting and Supporting Diversity in Medical School–The Case for Holistic Student Affairs</b> Presenters: C. Alexander Grieco, Ushasi Naha		CHEROKEE TRIANGLE
	<b>Encouraging Compassion: Students Supporting an Environment of Collegiality and Care</b> Presenters: Stacy Schmauss, Julie Johnson		BUTCHERTOWN
10:30–10:45	<b>BREAK</b>		
10:45–12:00	<b>Breakout Session 5</b>		
	<b>AAMC Update–Student Surveys</b> Presenter: Marie Caulfield		HIKES POINT
	<b>AAMC Update–AMCAS</b> Presenters: Chris Cooney, Patrick Fritz, PJ Kania		CRESCENT HILL
	<b>A Call for Critical Race Theory in Medicine–A Surgeon’s Approach</b> Presenter: Rashad J. Sullivan		GERMANTOWN
	<b>Leadership and Relationship Development for the Medical School Registrar using the GSA Professional Development Initiative</b> Presenters: Teresa Cook, Alisha Corsi		NULU
	<b>Mental Prep for Step at Ohio State University COM</b> Presenters: Megan Sayres, Lora Eberhard, Kelly-Ann Perry		OLD LOUISVILLE
	<b>When Students Stumble: A Case Study of a Struggling Student</b> Presenters: Ralph Manuel, Carol Elam, Sara Gottesman, Olivia Mittel		CHEROKEE TRIANGLE
	<b>“Per Policy, Student is Referred for Dismissal”: An Interactive Case-based Workshop to Discuss Challenging Issues</b> Presenters: Kathleen Kashima, Michael Kavan, Charles Pohl, T. Austin Witt		BUTCHERTOWN
12:00–1:30	<b>Lunch Plenary 2 - Guns and Violence: Is this our Lane?</b> Presenters: Ahmad Mostafavifar, MD, MBA and Monica Wendell, DrPH, MA		COMMONWEALTH 1/2/3/4
11:00–4:00	<b>Recruitment Fair</b>	11:00–12:30 Student/Parent Registration 12:30–1:15 Welcome & AAMC Pre-Med Services 1:15–2:00 Workshop for High School Students 1:15–2:00 Workshop for Collegiate Students 2:00–4:00 Recruitment Exhibits	OLMSTED 6 OLMSTED 6 OLMSTED 5 OLMSTED 7 COMMONWEALTH 5/6/7/8
1:45–3:00	<b>Breakout Session 6</b>		
	<b>AAMC Update–VSLO Update and Conversation with Experts</b> Presenters: Shanaz Sulejmanovic and Jesse Whitney		HIKES POINT
	<b>AAMC Update–SVI Update</b> Presenter: Renee Overton		CRESCENT HILL
	<b>Evidence-Based Care of the LGBTQ Patient Using the eQuality Toolkit (Workshop)</b> Presenters: Laura Weingartner, Emily Noonan, Amy Holthouser, Suzanne Kingery, Susan Sawning		GERMANTOWN



<b>Saturday, April 13, 2019 (continued)</b>		
1:45–3:00	<b>Breakout Session 6 (continued)</b>	
	<b>Development and Implementation of a Longitudinal Wellness Curriculum for the Largest U.S. Single-Campus Medical School</b> Presenters: Eva Waineo, Michelle Eventov, John Reba, Margit Chadwell	NULU
	<b>Medical Student Education on Interpersonal Violence</b> Presenter: Audrey Lane	OLD LOUISVILLE
	<b>Strategies for Diagnosing and Remediating Gaps in Clinical Competence</b> Presenters: Carrie A. Bohnert, Erica Sutton	CHEROKEE TRIANGLE
3:00–3:15	<b>BREAK with Snacks</b>	
		COMMONWEALTH PRE-FUNCTION AREA
3:15–4:45	<b>Breakout Session 7</b>	
	<b>Birds of a Feather—Financial Aid/ Student Records</b> Facilitators: Julie Brim, Christine McDonough, Barbara Gadzinski	HIKES POINT
	<b>Residency Explorer: New Tool in the Transition to Residency and Updates from AAMC’s Careers in Medicine</b> Presenter: Angelique Johnson	CRESCENT HILL
	<b>I belong: Fostering a sense of belong among students identified as URM through the creation of a cross-cultural cohort program</b> Presenters: Sacha Sharp, Antwione Haywood	GERMANTOWN
	<b>Increasing the Student Services Presence in the Medical Education Literature</b> Presenters: Christina J. Grabowski, C. Alexander Grieco, Mary Beth DeVilbiss	NULU
	<b>Emphasis on Now: Using Reflection to Promote Wellness Among Students</b> Presenters: Adrienne M. Edge, Christopher Bunt, Myra Haney Singleton	OLD LOUISVILLE
	<b>Academic Support in Medical Student Affairs: A Three-Part Model</b> Presenters: Christine R. Corral, Dijana Demirovic	CHEROKEE TRIANGLE
5:00–6:30	<b>Poster Reception</b>	COMMONWEALTH 1/2/3/4
9:30–10:00	<b>Thunder Over Louisville Fireworks</b>	
<b>Sunday April 14, 2019</b>		
7:30–8:45	<b>Joint GSA Breakfast</b>	COMMONWEALTH 1/2/3/4
7:30–8:45	<b>Central OSR Regional Business Meeting</b>	OLMSTED 7
7:30–8:45	<b>Southern OSR Regional Business Meeting</b>	OLMSTED 6
8:00–9:00	<b>Assessment of Resident Readiness Survey Tool Focus Group (Closed)</b> Facilitator: Amy Addams	NULU
9:00–10:00	<b>Plenary III: “Have you seen me?” Health Care Providers’ Role in Combatting Human Trafficking</b> Presenters: Olivia Mittel, Carrie A. Bohnert	COMMONWEALTH 6/7/8
10:00–10:15	<b>BREAK</b>	
10:15–11:30	<b>Breakout Session 8</b>	
	<b>New Student Orientation: Promoting Well-being and Resiliency from Day One</b> Presenters: Kristen Heath, Emily C. Walvoord, Antwione Haywood, Rebekah Roll, Kelly Matthews	NULU
	<b>Utilizing GSA PDI Tools to Enhance the Student Affairs Team</b> Presenters: Cary Chelladurai	OLD LOUISVILLE
	<b>Using Principles of Enrollment Management to Increase Gains from Holistic Review</b> Presenter: S. Elizabeth White, AAMC	HIKES POINT
	<b>When Bad Things Happen: Preparing Medical Students to Thrive After Adverse Events Curriculum Innovation with Videos and Discussion</b> Presenters: Eva Waineo, Michelle Eventov, Reba John, Diane Levine	GERMANTOWN
11:30	<b>MEETING ADJOURNED</b>	
12:00–2:00	<b>Post-Meeting Wrap-Up (Closed)</b>	HIKES POINT

# PLENARY SPEAKERS

## **Building Personal Resilience: Evidence-Based Practices for Student Affairs Professionals** **Michael Wiederman, PhD**



Michael Wiederman, PhD, is Professor of Biomedical Sciences and the Director of Professional Development at the University of South Carolina School of Medicine Greenville. He received his doctoral training as a clinical psychologist at Bowling Green State University in Ohio and completed a postdoctoral fellowship at the University of Kansas School of Medicine-Wichita. Working with faculty, staff, residents, and students, Dr. Wiederman provides individual coaching and a range of programming, much of it focused on leadership development and cultivation of emotional intelligence. Prior to joining the medical school, Dr. Wiederman was a clinical psychology professor for nearly 20 years. He is the author of numerous publications on a broad range of topics in psychology, healthcare and education.

---

## **Guns and Violence - Is this our Lane?**

### **Ahmad Mostafavifar, MD, MBA & Monica Wendell, DrPH, MA**



**A. Mehran Mostafavifar, MD, MBA**, is an Assistant Professor of Clinical Medicine in the Division of Hospital Medicine at The Ohio State University Wexner Medical Center. Dr. Mostafavifar attended medical school at the West Virginia University School of Medicine. He completed his residency in Internal Medicine at Jackson Memorial Hospital, a fellowship in sports medicine at Ohio State and earned a MBA at the OSU Fisher School of Business. In addition to dedication to medical education, Dr. Mostafavifar has developed a passionate interest in public health and advocacy and serves as the Chair of the Social Media Taskforce for the Columbus Medical Association.



**Monica Wendel, DrPH, MA**, serves as the Associate Dean for Public Health Practice and is Associate Professor of Health Promotion and Behavioral Sciences at the University of Louisville School of Public Health & Information Sciences. She also serves as Director of the Commonwealth Institute of Kentucky. She completed her B.A. Master of Arts and Master of Public Health and her Doctor of Public Health degrees at the Texas A&M University. Her interests lie in applied research related to community capacity building around social and health equity issues in such areas as gun violence, adolescent diversion programs, access to health care and health literacy.

---

## Have you seen me? Health Care Providers' Role in Combatting Human Trafficking

Olivia Mittel, MD, MS & Carrie Bohnert, MPA, CHSE



**Olivia Mittel, MD, MS**, serves as Associate Dean for Medical Student Affairs and Associate Professor of Pediatrics in the Division of Pediatric Hospital Medicine at the University of Louisville School of Medicine. She attended medical school at the University of Louisville and completed residency and Chief Residency in Pediatrics at Loyola Stritch School of Medicine in Chicago. Her career passion is developing medical students into professional and skilled healers who are prepared for today's team-oriented healthcare setting. Together with the standardized patient team at ULSOM, Dr. Mittel developed an innovative medical education curriculum to educate and evaluate healthcare practitioners' awareness and recognition of human trafficking in acute care settings. She serves on the Education Committee of HEAL Trafficking, a national network of healthcare providers dedicated to ending human trafficking and supporting its survivors.



**Carrie A. Bohnert, MPA, CHSE**, is a simulation educator at the University of Louisville School of Medicine. Ms. Bohnert and research partners Dr. Olivia Mittel, Dr. Jennie Green, and Dr. Aaron Calhoun have published several papers on medical education's response to human trafficking. The team has also received grants from the Committee on Medical Student Education in Pediatrics and the Association of Standardized Patient Educators for their work teaching healthcare practitioners to recognize the signs and symptoms of human trafficking.

Ms. Bohnert is chair of the board of directors of People Against Trafficking Humans (PATH) Coalition of Kentucky. She previously served on the board of the Association of Standardized Patient Educators, for which she co-authored standards of best practice for standardized patient-based simulation.

---

### **Movie: *Rubbertown*—a documentary examining a neighborhood of heavy industrial manufacturing plants and the effect on residents followed by discussion**

**Aruni Bhatnagar PhD, FAHA**



Widely regarded for spearheading the new field of Environmental Cardiology, **Dr. Aruni Bhatnagar**, a Smith and Lucille Gibson Professor of Medicine at the University of Louisville, has spent more than 25 years studying the impact of toxic substances, tobacco smoke constituents and environmental pollutants on heart disease. He is a graduate of Kanpur University, India and received his post-doctoral training at the University of Texas Medical Branch at Galveston. Dr. Bhatnagar is known for his pioneering work on the metabolism of toxic substances in ambient air and tobacco smoke, and how they affect the development of cardiovascular disease and diabetes. He has published over 280 research papers, commentaries and review articles, and 20 book chapters. A leader in cardiovascular health, he has participated in more than 50 peer-review panels of the National Institutes of Health, and has served as a member of the Institute of Medicine's Committee on Secondhand Smoke Exposure and Acute Coronary Events. He currently serves as Director of the newly created Christina Lee Brown Envirome Institute, and the Diabetes and Obesity Center at the University of Louisville and Director of the American Heart Association Tobacco Regulation and Addiction Center.

# OMNI LOUISVILLE HOTEL MEETING SPACE

## LEVEL TWO

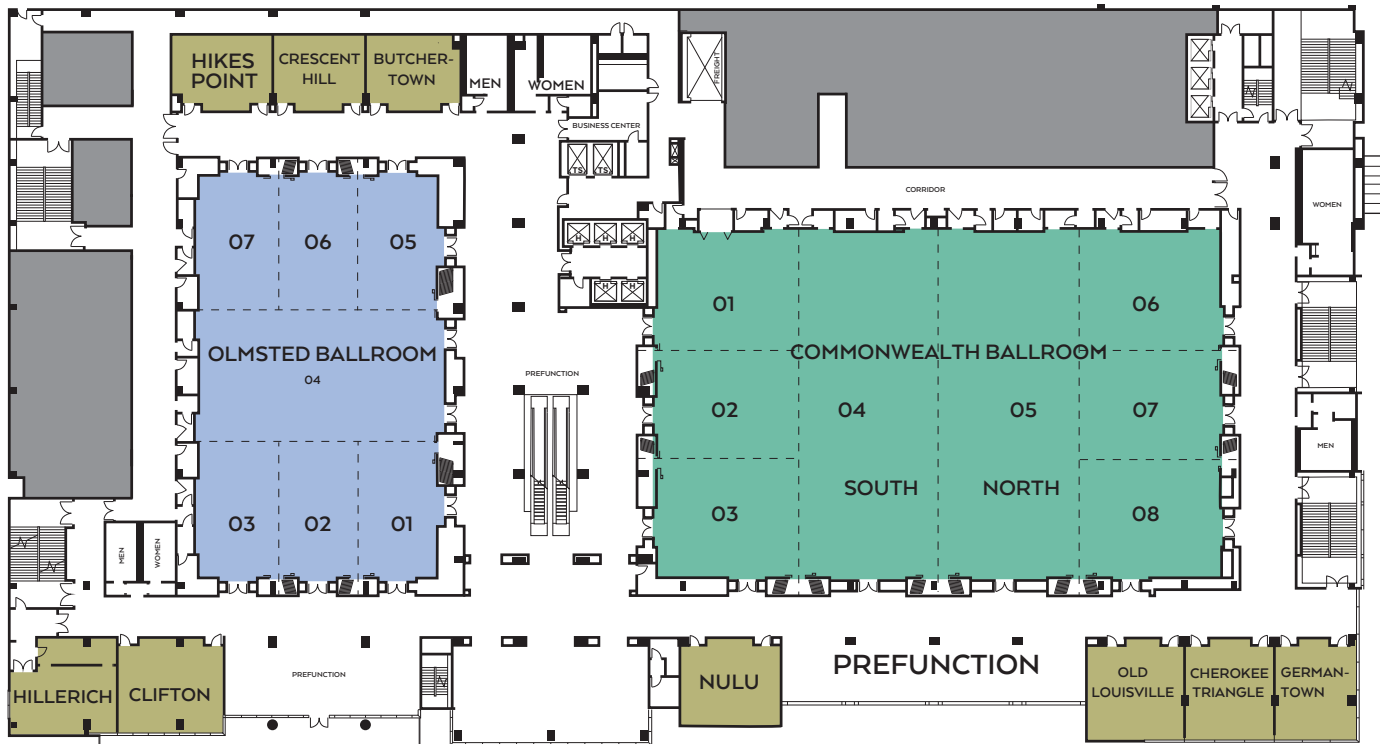

## LEVEL THREE

